

SERVICES FOR THE CUSTOMER

- Supporting customer in product design and development
- Design and product validation (DV and PV)
- Metal stamping and injection molding of components
- Supply of automatic and manual assembling lines and testing benches

BLOWER SWITCHES

DESCRIPTION:

The A/C blower switch is an electromechanical component that allows the setting of the fan speed of the car interior conditioning and, through a pushing button, the on/off setting of conditioning (HVAC control). At present, MISTA produces around 20 families of blower switches for a global amount of 2.000.000 of pieces per year.

TECHNICAL FEATURES:

- Up to 5 positions for 4 speeds
- Total turning angle: 120°C or 180°C
- Max. Current flow over 4 speeds: 28-30 A
- Max. Voltage: 13,5 V
- Working temperature: -40°C / +85°C

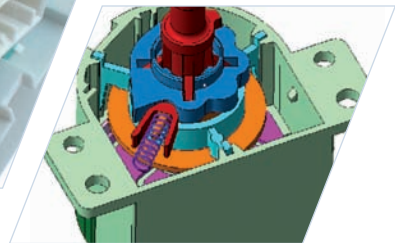
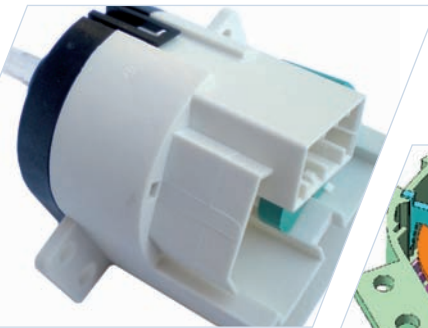

A - Blower switch

4-speed, A/C push button and integrated circuit in the inner body; without PCB



B - Blower switch

4-speed, two push buttons for A/C and heating; circuit in sight

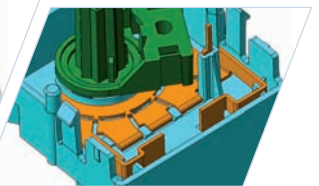

C - Blower switch

4-speed, with power supply pin for PCB

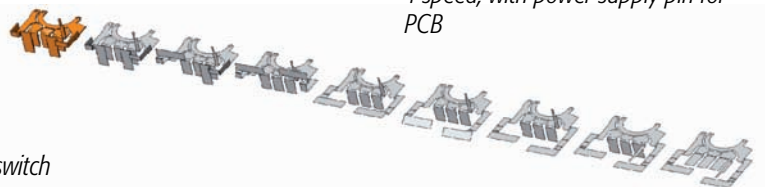

D - Rotary power switch

4-speed, with PCB integrated inside the switch body

